

# Weathersfield Wildlife Management Area

## General Description

Weathersfield WMA is an 80-acre parcel sandwiched between Route 5 and Interstate 91 in the town of Weathersfield. It is owned by the State of Vermont and managed by the Vermont Fish & Wildlife Department. Access is by foot only from Route 5 along the eastern boundary.

## History

The property was purchased with revenues from hunting license sales. The Atkinson-Davis Corporation retained the timber rights at the time of the sale.

## Habitat Features

Weathersfield WMA is in the Southern Piedmont biophysical region of Vermont. The topography of Weathersfield WMA rises steeply from Route 5 and then levels off. It is predominantly forested with typical northern hardwoods – sugar and red maple, yellow birch and beech. White pine is scattered throughout the parcel.

There are no rare, threatened or endangered species, or significant natural communities documented.

## Common Fish and Wildlife

**Mammals** White-tailed deer, red and gray fox, fisher, raccoon, coyote, red squirrel and chipmunk are common mammal species that may be found on the WMA. Bat species and various rodents, moles, voles and shrews are also present but are not as easily detected.

**Birds** Turkeys are present and may be hunted in season. Songbirds, woodpeckers and forest raptors may also be seen or heard.

**Reptiles and Amphibians** Red-backed salamander, American toad and gartersnake may be found in the northern hardwood forest of the WMA. Listen for spring peepers near vernal pools in early spring.

**Fish** There are no fishable waters on the WMA.



A spring peeper clings to a fern. VFWD photo.

Weathersfield WMA is open to regulated hunting, trapping, hiking and wildlife viewing.



# Vermont Fish & Wildlife Department Weathersfield Wildlife Management Area

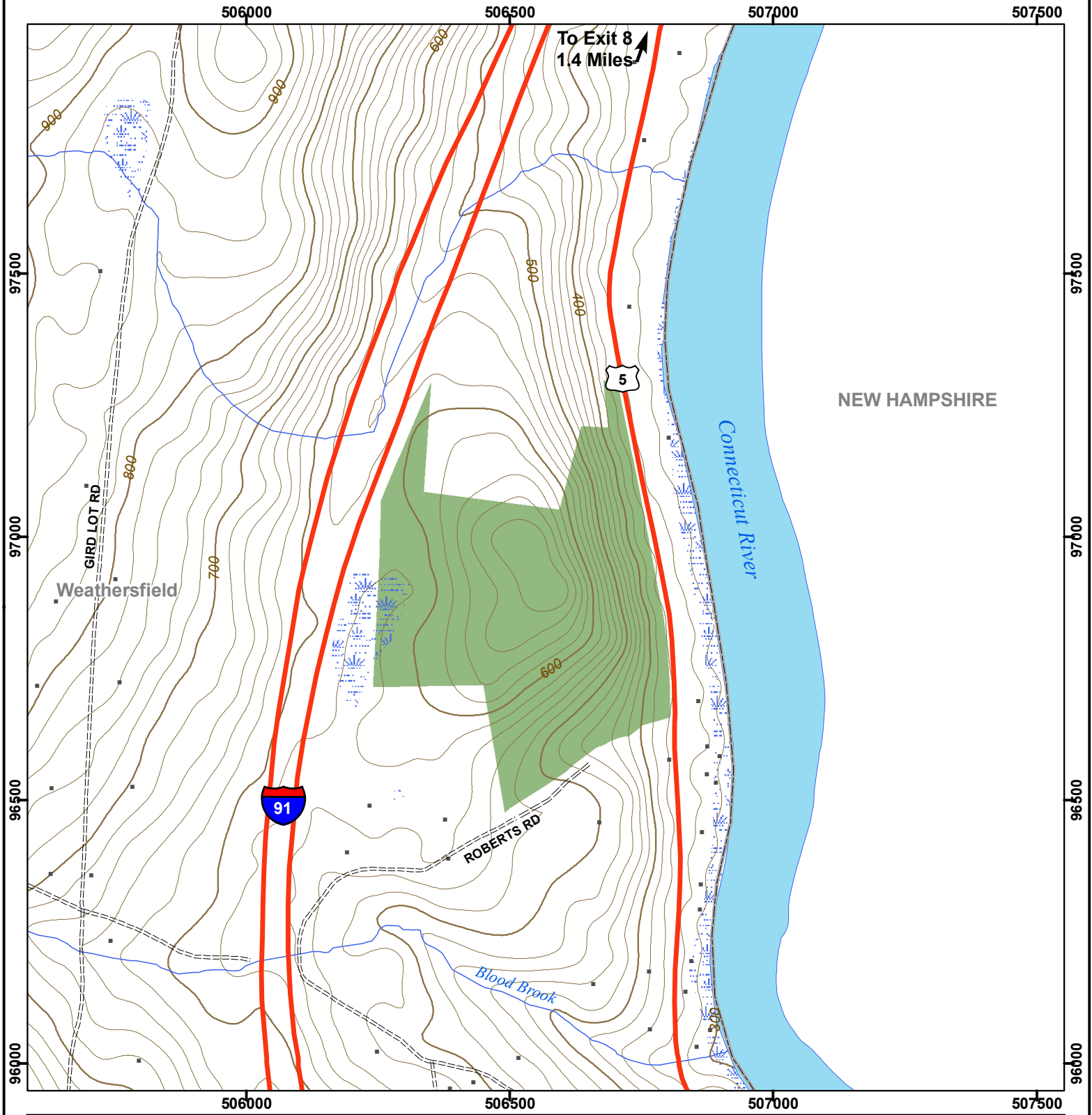

## Weathersfield WMA: 80 acres

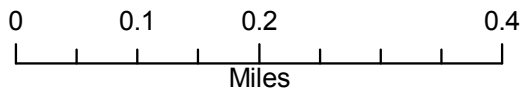

- Wildlife Management Area
- Other Public Land
- Private with Public Access
- Wildlife Viewing Areas
- Car-top Access
- Parking
- Boat Ramp
- Gate
- Designated Camp Site During Big Game Seasons Only

This map is for illustrative purposes only. The accuracy of the data layers shown on this map are limited by the accuracy of the source materials. No warranty as to the accuracy or the usefulness of the data is expressed or implied.